



Golden Mile
APARTMENTS



Golden Mile
VILLAS



HAUSSMAN IMPEX
PVT. LTD

DEVELOPERS

KMINP

LEGAL ADVISOR



ARCHITECTS & CONSULTANTS



GOLDEN MILE
APARTMENTS

SPECIFICATIONS

STRUCTURE

Seismic Zone 2 compliant structure
Concrete solid block masonry

PLASTERING

All internal walls are smoothly plastered with lime rendering

PAINTING / POLISHING

Interior: Oil bound distemper painting
Exterior : Exterior emulsion paint
Enamel paint for MS grill/door shutters
Teak surface provided with melamine polish

PLUMBING

All Plumbing lines are pressure tested
Sewer lines will be of PVC make

FLOORING

Vitrified tiles for living and dining areas
Superior quality ceramic tiles for bedrooms, balconies, kitchen areas
Designer ceramic tiles for all toilets

TOILETS

Glazed/ceramic tiles dado in false ceiling (7 feet height)
EWC and wash basin in all toilets of Hindware make/equivalent/imported
Hot and cold water mixer unit for shower in Master Bed room Toilet
Wash Basin Mixer in master bed room Toilet
Health faucet will be provided in all toilets
Provision for one geyser in all toilets
Large sized toilet ventilators in fixed glass with provision for exhaust fan

MAIN DOOR

Teak Wood Door frame with threshold designer door shutters, finished with melamine polish on both sides
Aluminium/hardware with night latch and magic eye

OTHER DOORS

Seal wood door frames
Commercial flush shutter for bedrooms with enamel paint
PVC coated flush shutter with enamel paint for toilets and terrace door
Aluminium powder coated sliding doors with plain glass for balcony
Aluminium powder coated /hardware for all doors

WINDOWS

Powder coated Aluminium sliding windows with plain glass, in three tracks with provision for mosquito mesh safety grills

KITCHEN

Provision of plumbing points for sink and electrical points to accommodate modular kitchen
Cladding with glazed tiles above the kitchen platform location
Granite kitchen platform with stainless steel sink
Aqua-guard point in kitchen
Washing machine point in utility area
Gas cylinder points in utility area with copper pipe

ELECTRICAL

One TV point in the living room and master bedroom
Fire resistant electrical wires of Anchor/Finolex make
Elegant modular electrical switches of Anchor make or equivalent
For safety, one Earth Leakage Circuit Breaker (ELCB) for the House
Each House will be provided with 5 KW power
Telephone point will be provided in living room and each bedroom

OTHERS

Water Purifier
Backup Generator

HIGHLIGHTS

- JUST 8KMS BEFORE INTERNATIONAL AIRPORT
- VERY CLOSE TO UPCOMING AEROSPACE, HARDWARE PARK AND SOFTWARE PARK
- MODERN ARCHITECTURE WITH 100% VAASTU COMPLIANCE
- INDIVIDUAL PRIVACY
- CLOSE TO TOP INTERNATIONAL SCHOOLS
- ROUND THE CLOCK SECURITY

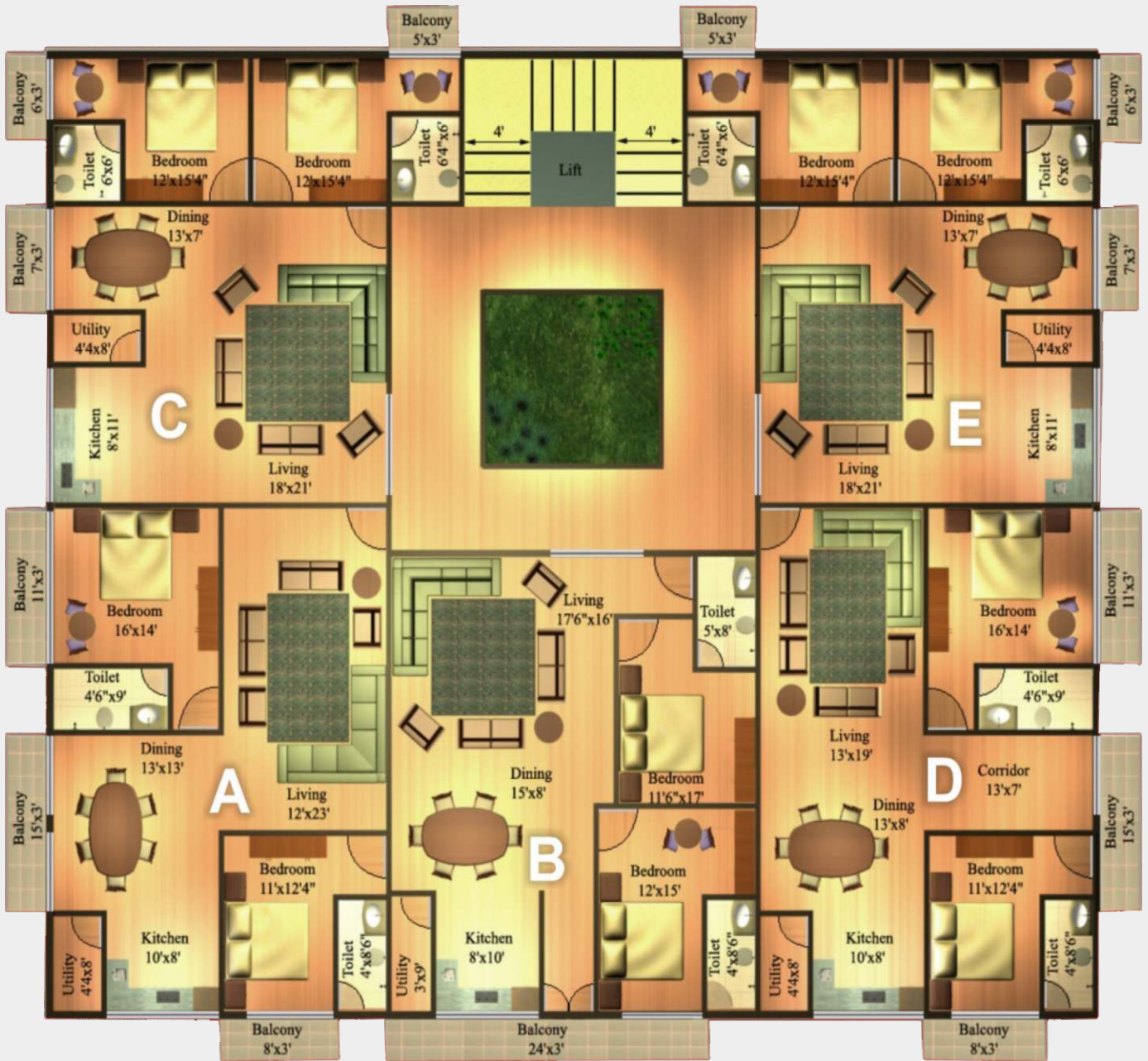

TYPICAL FLOORPLAN

4 STOREYED BUILDING WITH 5 UNITS ON EACH FLOOR
SUPER BUILT UP AREA OF EACH UNIT-1350 SQ FT







ROUTE MAP

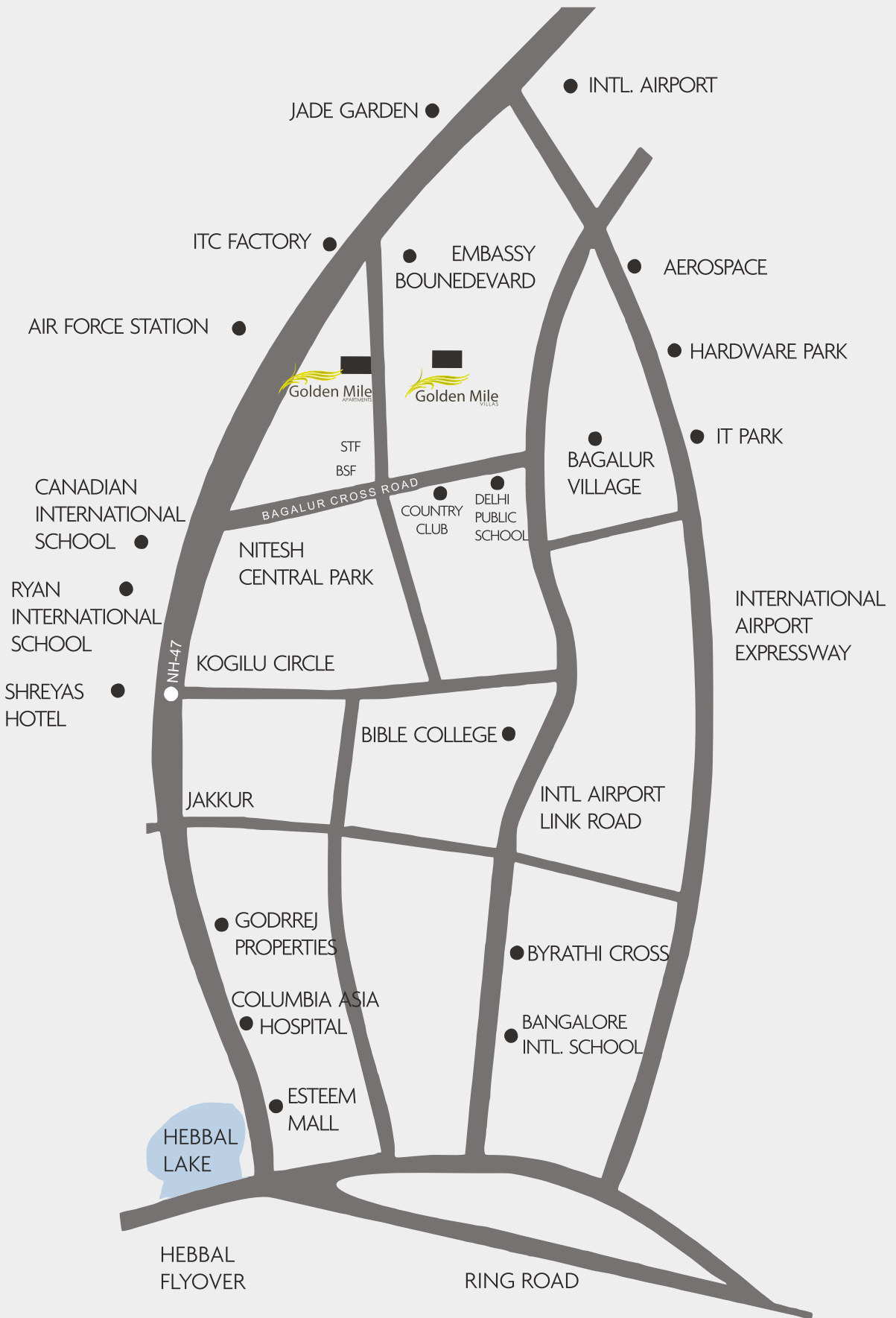



#7, PRIYANKA VILLAS, BAGALURU ROAD, BANGALORE-560077, INDIA
TEL: +918065331100 MOB: +918095817171

MIDDLE EAST OFFICES

SHARQ-AHMED AL-JABER STREET, KIRBY BUILDING-4TH FLOOR
SAFAT-CODE 13154, KUWAIT-P.O.BOX: 29357

ABU DHABI-P.O.BOX:48013,UAE

www.dreamworksme.com

